

# Inductor for power line radial

## 『TZSL135135CA SERIES』



### ■ Features

- Low DC resistance and High power capacities
- Magnetically shielded construction.
- Bulk packing.
- Applies to Variety of electronic equipments.

### ■ 特長

- 低抵抗、高出力。
- 閉磁路タイプで雑音が小さい。
- パルク梱包です。
- 種々の電子装置に応用出来ます。

### ■ Dimensios

Appearance/外觀



Dimensions/形状寸法

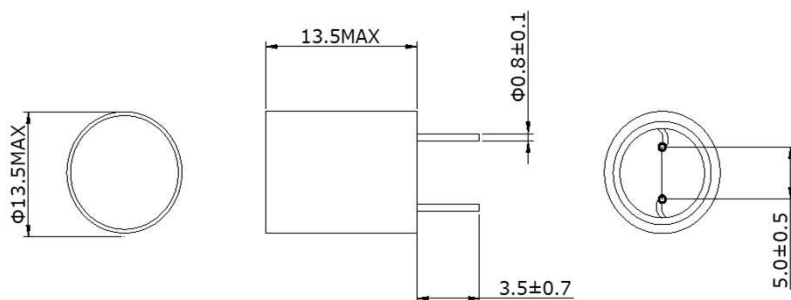

### ■ Electric Spacifications/電気特性

#### ● TYPE TZSL135135CA (φ 13.5mm × 13.5mm Hight)

DSC Part Number	Inductance (μH)		DC Resistance (Ω) MAX	Rated current (A) MAX
		公差		
TZSL135135CA- 2R2	2.2	± 20%	0.008	11.0
TZSL135135CA- 3R3	3.3		0.011	10.0
TZSL135135CA- 4R7	4.7		0.013	8.20
TZSL135135CA- 6R8	6.8		0.015	7.00
TZSL135135CA- 100	10		0.018	6.30
TZSL135135CA- 150	15		0.028	4.70
TZSL135135CA- 220	22		0.038	3.70
TZSL135135CA- 330	33		0.055	3.20
TZSL135135CA- 470	47		0.080	2.80

### ■ Conditions/測定条件

(1)The rated DC current is that which cause a 30% inductance reduction from the initial value or inductor surface temperature to rise by 40°C, whichever is smaller.

定格電流は、インダクタンスが初期値から30%低下又は、表面温度が40°C上昇のいずれか小さい方の値です。

(2)The measuring frequency and surroundngs temperature are 100 kHz and 25°C, respectively.

測定周波数: 100kHz。測定周囲温度: 25°C。